

INSTALLATION MANUAL

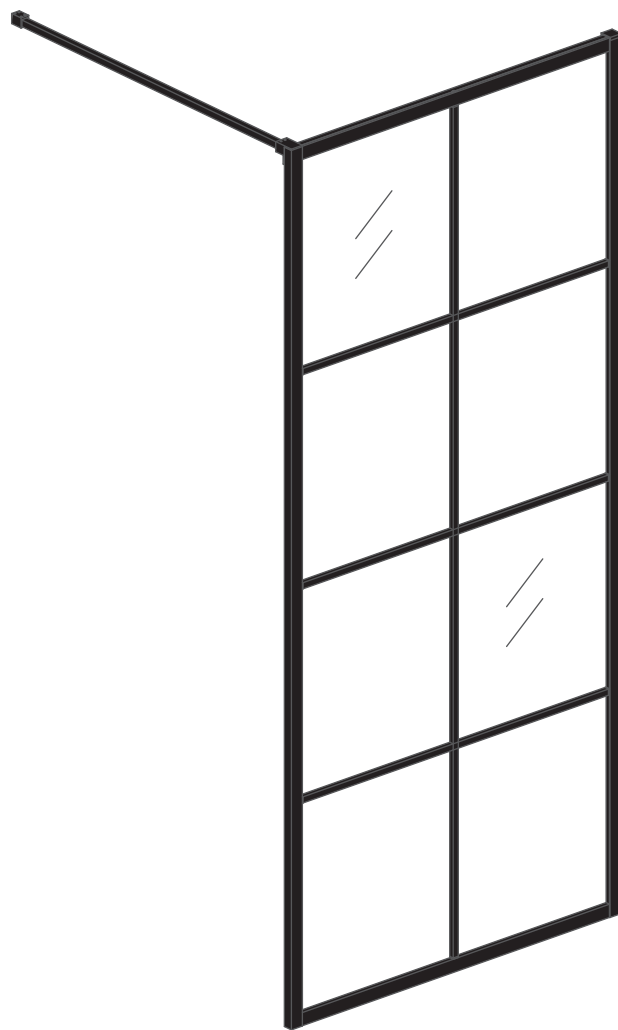

BEKO80/BEKO90/BEKO100
BEKO120/BEKO140

RoHS **CE** ISO9001:2008

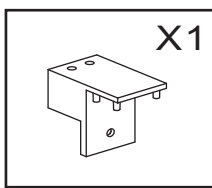
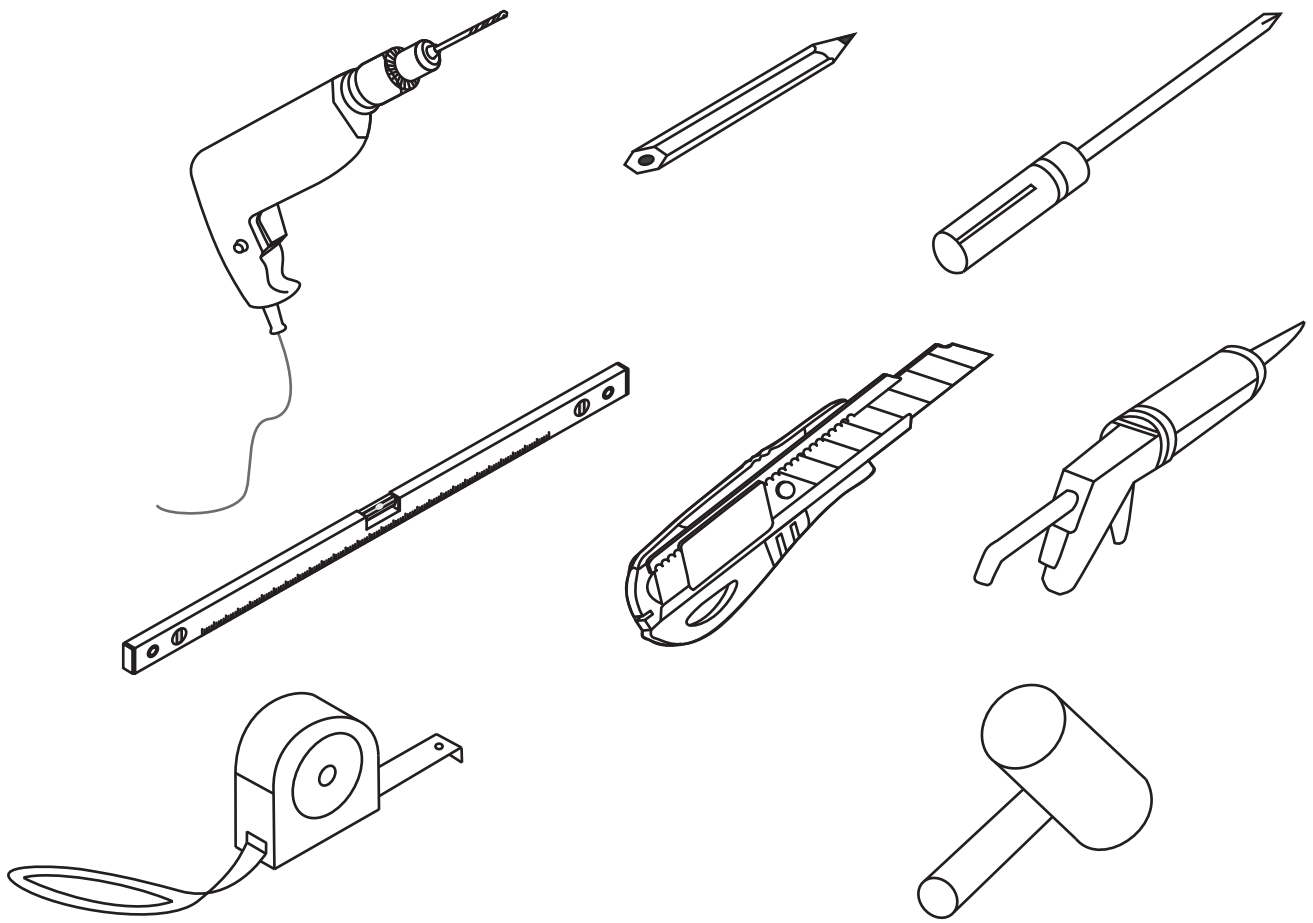

X1

PJ-4230

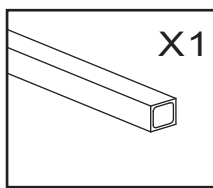

X1

LG-04

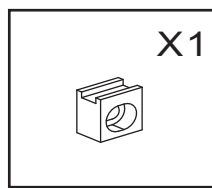

X1

PJ-4207

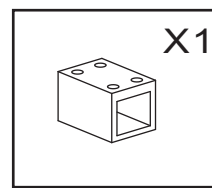

X1

PJ-4206

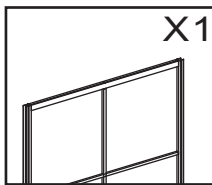

X1

GLASS

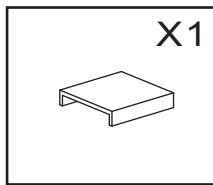

X1

KQ-47cover

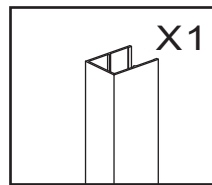

X1

BK-25

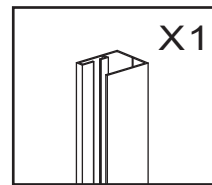

X1

KQ-47

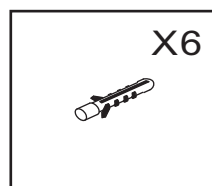

X6

PJ-4606

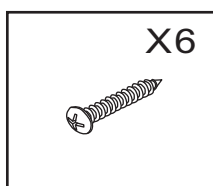

X6

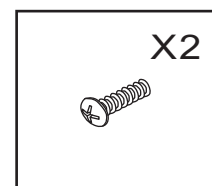

X2

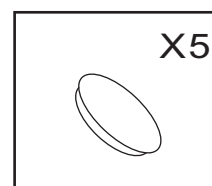

X5

Drawing the install size.

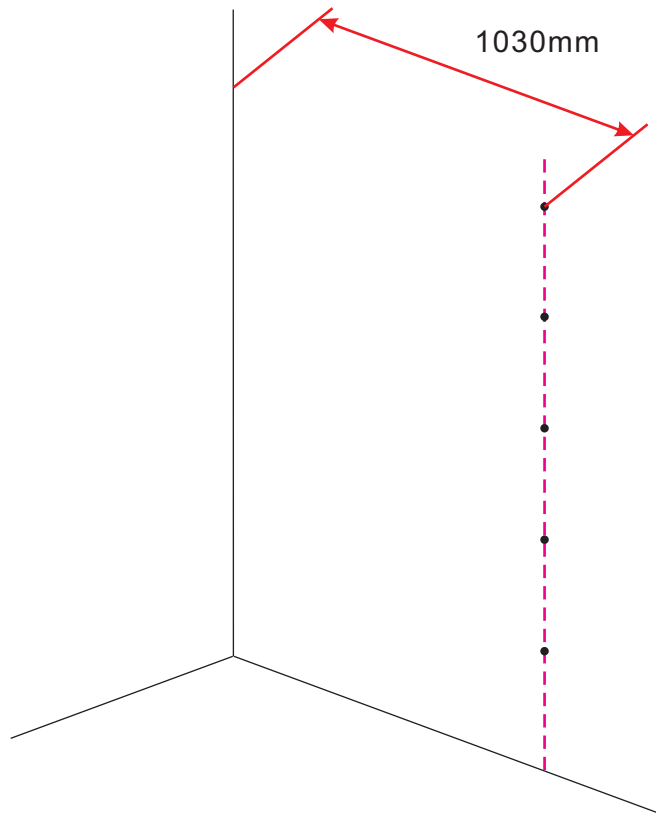

1

Install the wall profile.

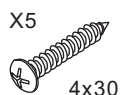
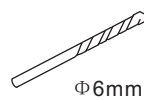
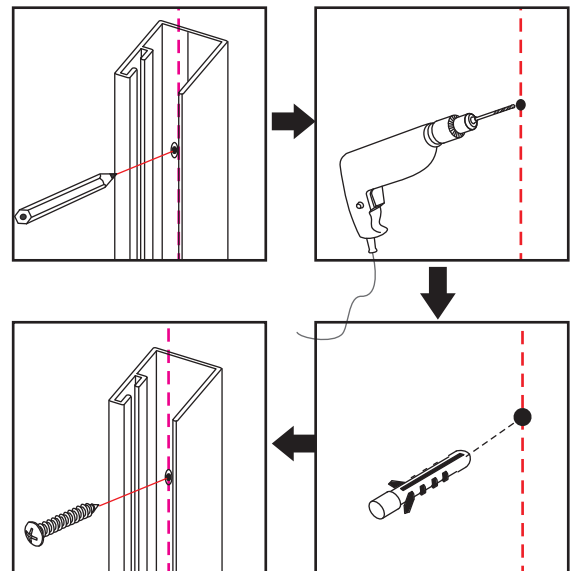
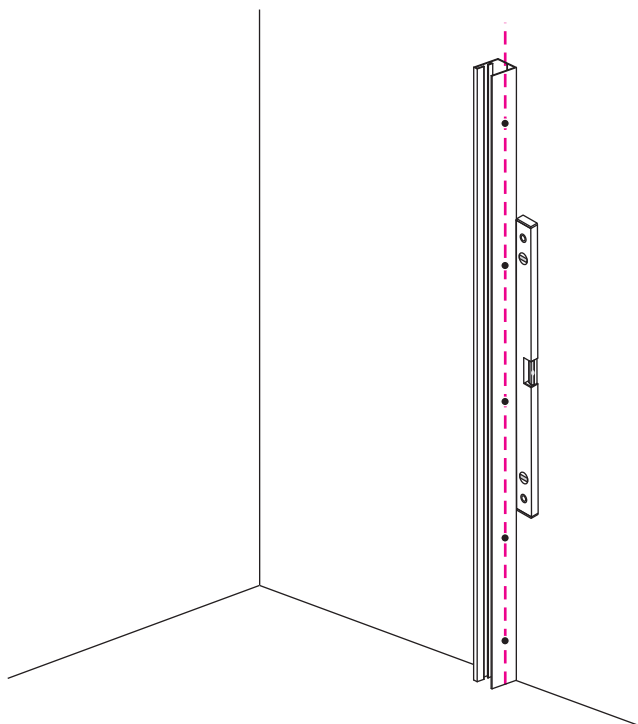

2

Install the fixed glass.

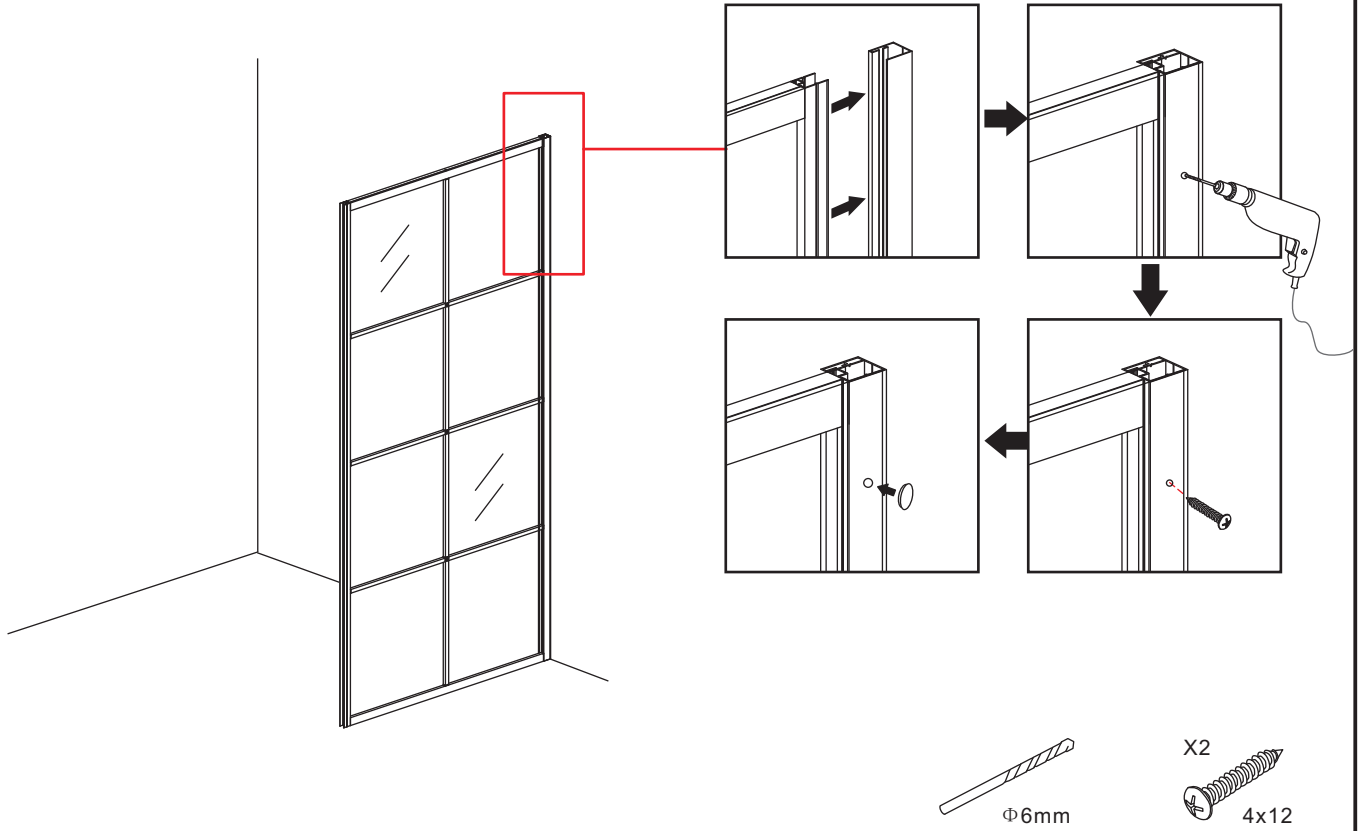

3

Install the frame profile of broadside fixed glass.

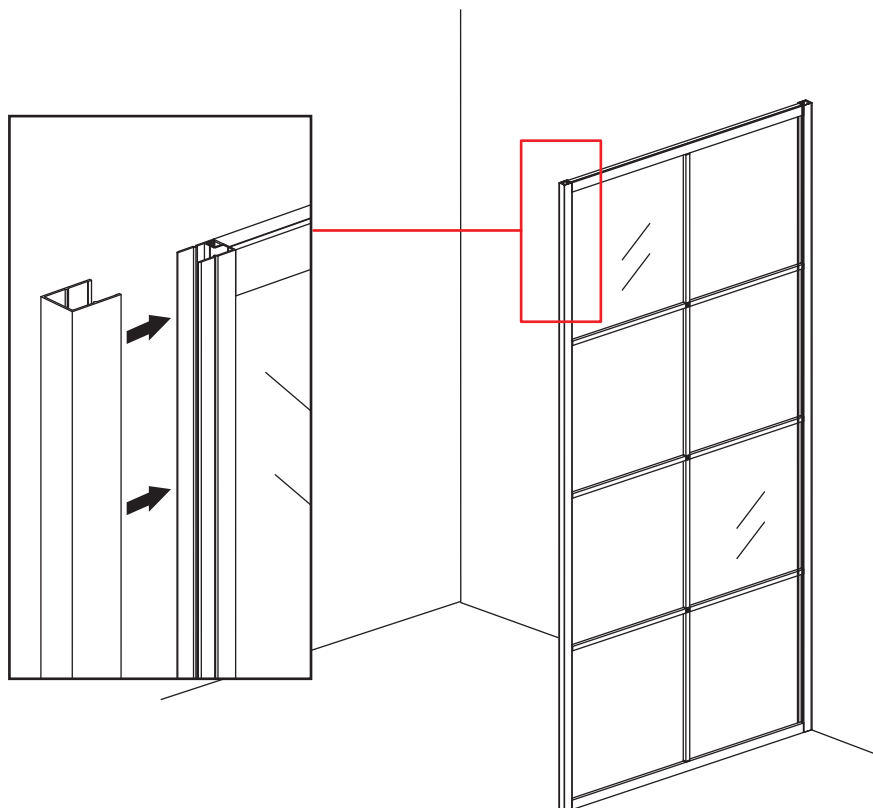

4

Install the top decorate part.

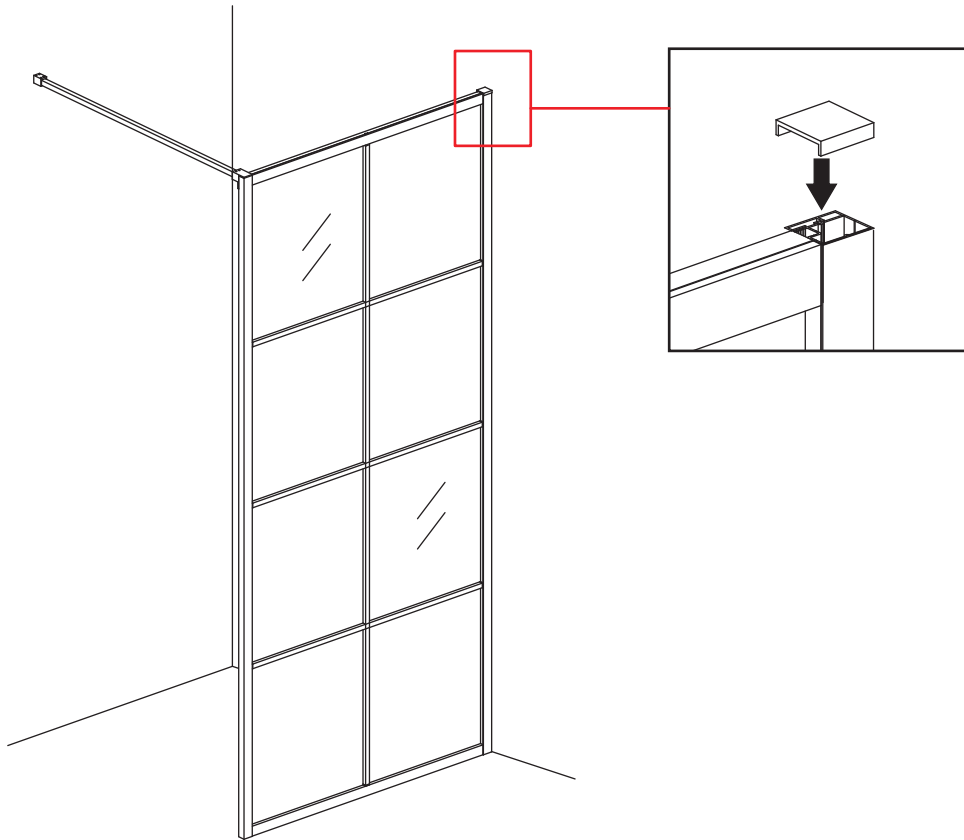

7

Make the glass gel then make sure without shower in 24hours.

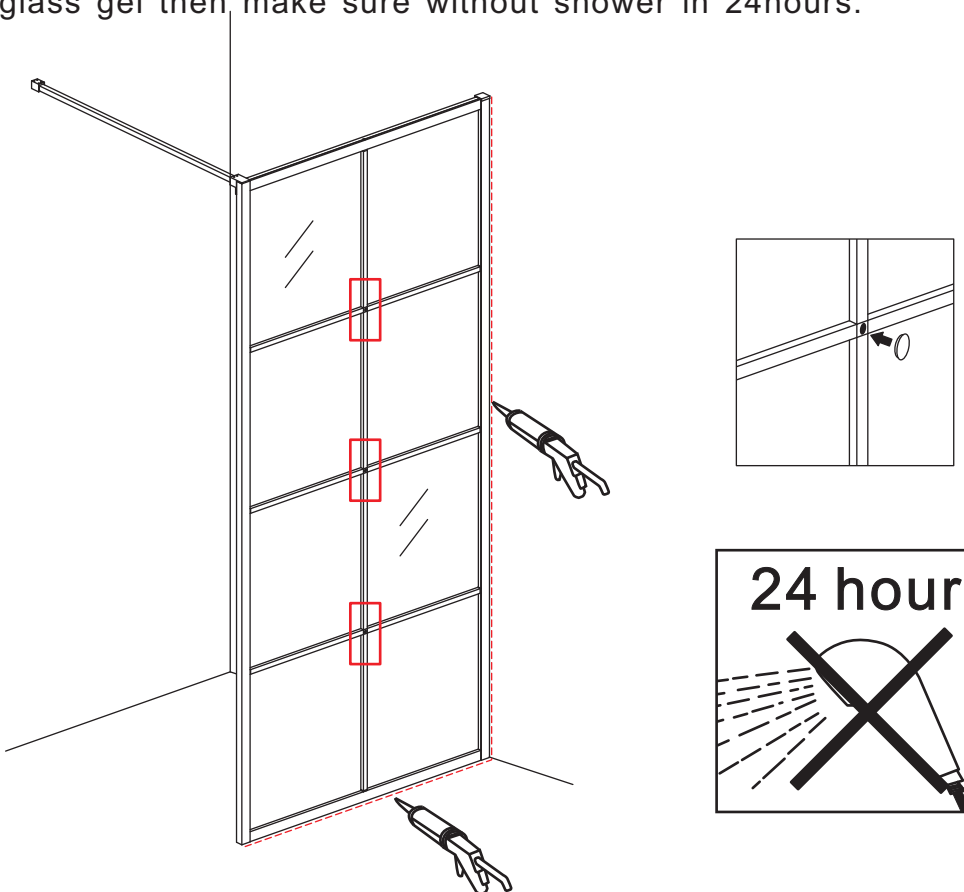

8